

MODEL :		TYPE
PROJECT :		
PREPARED BY :	DATE :	

## SERIES SPECIFICATIONS

The IB series I-Beam LED high bays are ideal for manufacturing, warehousing, commercial and industrial facility lighting applications. The superior design makes it a sturdy, user friendly and easy to install high bay.



## LINE DRAWING

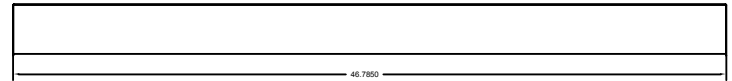
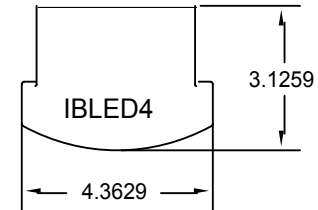
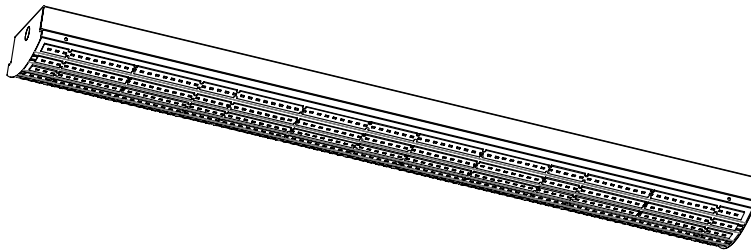

## CONSTRUCTION

### Housing

The body is constructed of 24 gauge, USA made commercial grade steel with a hot dipped galvanized finish (6 mgs on both sides).

### Paint

Paint after fabrication of the galvanized body also means that this fixture is highly resistant to rust over its lifetime.

### Lamp Bars

24 gauge, hot dipped galvanized steel

### Rockwell Hardness Rating

RB 40 to 65

## ELECTRICAL SPECIFICATIONS

Output Power Max  
85W (Per Driver)

Line Regulation  
< 5%

Load Regulation  
< 5%

Typical Voltage @ 55°C @65mA  
44.9 (Per Board)

Output Current Ripple  
<25% of DC value

Input Voltage  
120-277 VAC

MODEL :		TYPE
PROJECT :		
PREPARED BY :	DATE :	

## ELECTRICAL SPECIFICATIONS CONT.

Frequency 50-60Hz	CRI > 80	Color Temp 5000K
Input Current Max .85 @ 120 (Per Driver) .37 @ 277 (Per Driver)	Output Voltage 30V-55VDC @ 2.0A (Per Driver)	THD <20%
Input Wattage Max 93W (Per Driver)	Max. Output Current 2100mA (Per Driver)	Inrush Current 18A Peak @ 120V (Per Driver) 32A Peak @ 277V (Per Driver)
Power Factor ≥ 0.9	Operating Temp -40°C- +85°C	Dimming Low Voltage 0-10V

\*Please consult factory for list of approved dimmers

## PERFORMANCE SPECIFICATIONS

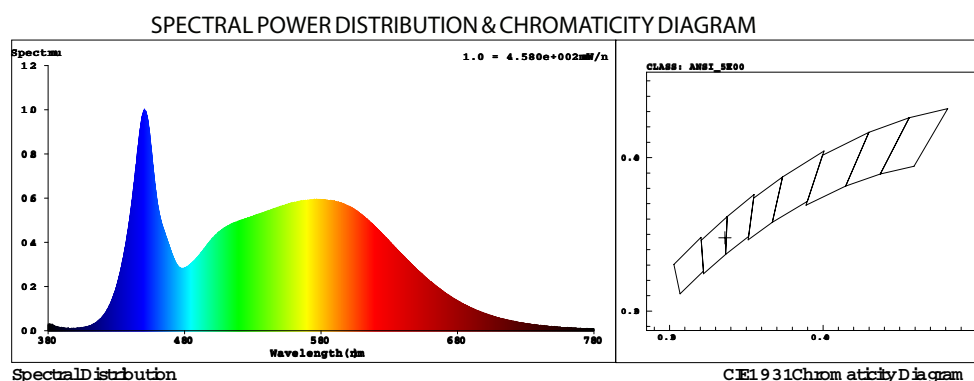

## CERTIFICATIONS/WARRANTY

Listing  
UL Listed

Location Rating:  
Suitable for damp locations

Warranty

Guaranteed for five years from the purchase date of the product, against mechanical defects in manufacturing.

DLC Listing  
Fixtures are DLC listed and featured on the Qualified Products List (QPL).\*\*

Assembled in USA  
This product has been Assembled in the USA

MODEL :		TYPE
PROJECT :		
PREPARED BY :	DATE :	

## PERFORMANCE SPECIFICATIONS

Target Lumens	Lumens @ 3000K	LPW @ 3000K	Lumens @ 3500K	LPW @ 3500K	Lumens @ 4000K	LPW @ 4000K	Lumens @ 5000K	LPW @ 5000K	Max Wattage	Amps @ 120V	Amps @ 277V
15000	14340	128	14535	129	15307	137	15021	135	112	0.93	0.40
17500	16584	125	16665	126	17548	134	17430	133	132	1.10	0.48
20000	19517	119	19531	119	20643	127	20540	126	163	1.36	0.59

## ORDERING INFORMATION

Sample Part Number: IBLED44-200D2L850

Carton Dimensions: 126.365x20.638x13.97CM  
49.75x8.125x5.5IN

Pallet Quantity: 40 PCS

IBLED	4	4		D2	L850
SERIES	LENGTH	No. of BOARDS	TARGET LUMENS	No. of DRIVERS	COLOR TEMP
IBLED	[4] : 4'	[4] : 4 Boards	[150] : 15000 Lumens	[D2] : 2 Drivers	[L850] : 80 CRI 5000K
			[175] : 17500 Lumens		[L840] : 80 CRI 4000K
			[200] : 20000 Lumens		[L835] : 80 CRI 3500K
					[L830] : 80 CRI 3000K

## NOTES

Fixture are not surface mount capable without surface mount bracket.

\*\*Not all product variations meet Design Light Consortium Qualifications. Please verify that the product is listed on the DLC products list at [www.designlightconsortium.org/QPL](http://www.designlightconsortium.org/QPL).

Photometric Data based on 80 CRI 5000K

MODEL :		TYPE
PROJECT :		
PREPARED BY :	DATE :	

## SURFACE MOUNT ACCESSORIES

### TW-IB4-BR - Surface Mount Bracket

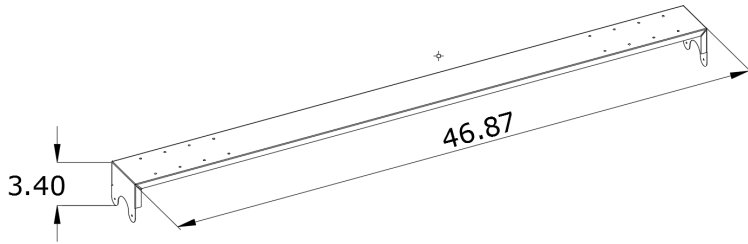

#### Material

24 gauge, hot dipped galvanized steel

#### Paint

Paint after fabrication of the galvanized bracket also means that this fixture is highly resistant to rust over its lifetime.



APPLICATION AND PERFORMANCE SPECIFICATION INFORMATION IS SUBJECT TO CHANGE WITHOUT NOTIFICATION

660 NW PEACOCK BLVD.

PORT ST. LUCIE, FL 34986

TEL: 772.879.0178

TAMLITEUSA.COM